

CSI

Primarily designed for installation where powerful illumination with excellent color rendering is required, as in sports arenas and sports stadiums. Also suitable for architectural lighting where a narrow, high-intensity beam is required.

- Compact high intensity floodlight
- Sealed beam lamp keeps integral reflector clean
- Hot restrike version available for use where instant restrike is essential
- Choice of 5 front lenses to vary beam distribution
- Rear relamping without luminaire being moved from its locked-in aiming position.
- Colored dichroic lenses available - consult factory
- Remote ballast installation only - up to 200 feet

Lamps

1000W Metal Halide PAR64 compact source iodide (CSI)
1000W PAR64 Quartz and other lamp types - consult factory

Materials/Finish

Housing: Two piece, marine grade - copper free, die cast aluminum
Housing latches: Stainless steel
Retaining ring gasket: Silicone
Front glass retaining ring: Aluminum
Front lens: Heat resistant borosilicate glass

Installation/Mounting

Choice of single yoke or four-way bracket.
For other mounting brackets - consult factory.

The CSI features a 2 section main housing. The front section contains the gasketed borosilicate glass lens and attaches to the yoke or 4-way mounting bracket. The rear section houses the lamp, ignitor and wiring terminals. Three stainless steel latches fasten the 2 section together.

Standards

Ballast - UL recognized
Fixture - ETL approved

Specification

To specify state:
Enclosed floodlight with 2 piece die cast aluminum housing for 1000W metal halide PAR64 compact source iodide lamp, with ignitor in wiring box and remote ballast. As North Star CSI Series.



SINGLE FLOODLIGHT

Weight = 21.78 lbs
EPA = 0.8 sq. ft.

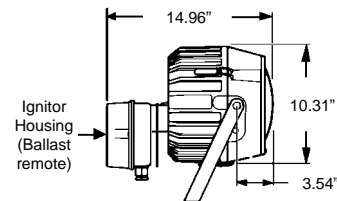

SINGLE FLOODLIGHT ON OQA YOKE

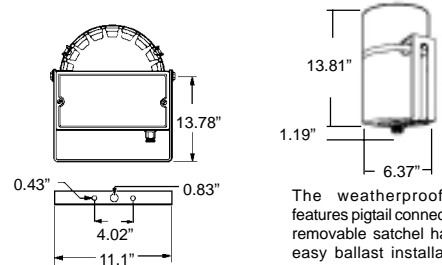

The weatherproof ballast features pigtail connections, and removable satchel handles for easy ballast installation, and transportation. (Weight = 45 lbs)

4 FLOODLIGHTS ON QQB4 BRACKET

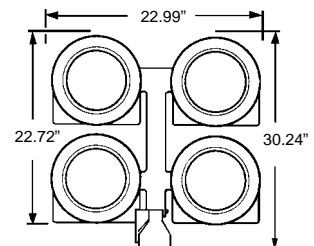

Weight = 83.8 lbs
EPA = 3.25 sq. ft.

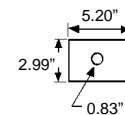

QQB4 BASE PLAN



NORTH STAR LIGHTING INC.

2150 PARKES DRIVE ♦ P.O. BOX 6038 ♦ BROADVIEW, ILLINOIS ♦ 60155-6038 ♦ 708-681-4330 ♦ FAX 708-681-4006

Web Site: www.nslights.com

THORN

Field Angle to 1/10 maximum candle power.

| LENS | FIELD ANGLE (HxV) | NEMA TYPE | TOTAL EFFICIENCY (%) |
|-----------------|-------------------|-----------|----------------------|
| C - Clear | 15.7 x 16.7 | 1 | 65.4 |
| S - Stippled | 17.9 x 18.3 | 2 | 58.8 |
| P - Prismatic | 36.1 x 25.7* | 3 x 2* | 63.8 |
| W - Wide Spread | 72.8 x 39.9* | 5 x 3* | 62.6 |
| E - Extra Wide | 102.8 x 95.7 | 6 x 5 | 60.8 |

* - "P" and "W" lenses may be rotated to give desired horizontal and vertical spread.

Hot Restrike Run-Up Time

| Lamp "Off" Period | Time for Light Output to Reach 90% of Final Value |
|----------------------|---|
| Normal "cold" run-up | 56 secs |
| 5 minutes | 35 secs |
| 3 minutes | 27 secs |
| 2 minutes | 25 secs |
| 1 minute | 10 secs |
| 30 seconds | 2 secs |
| 15 seconds | Less than 2 secs |

ORDERING EXAMPLE (Select desired item from each column)

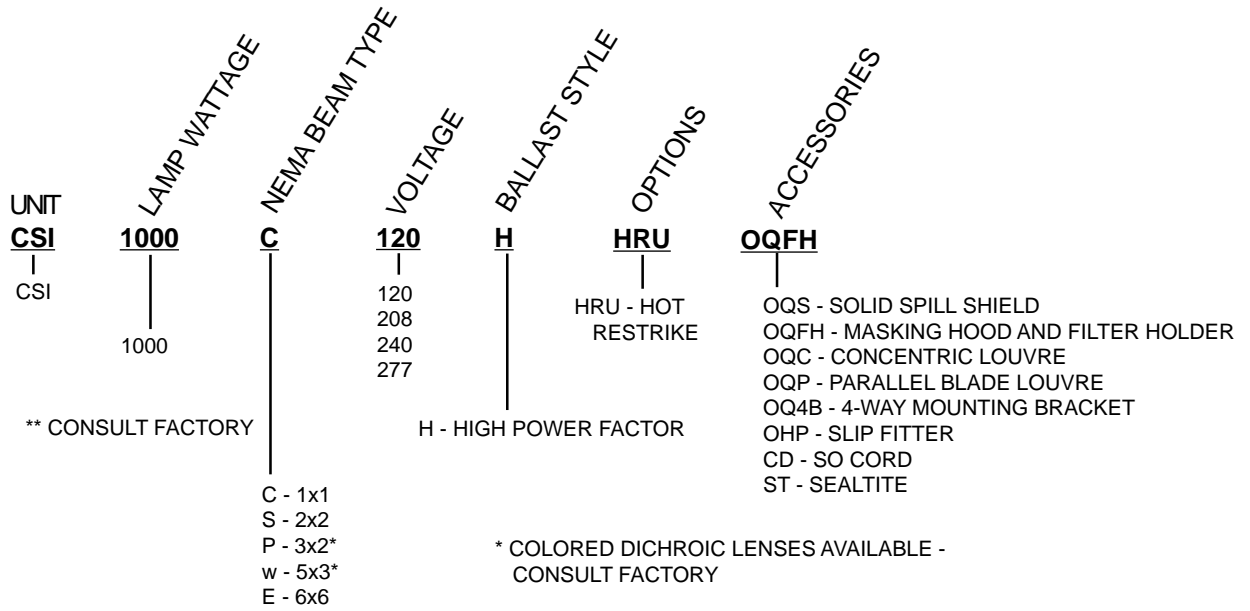

LAMP/SOCKET ORIENTATION

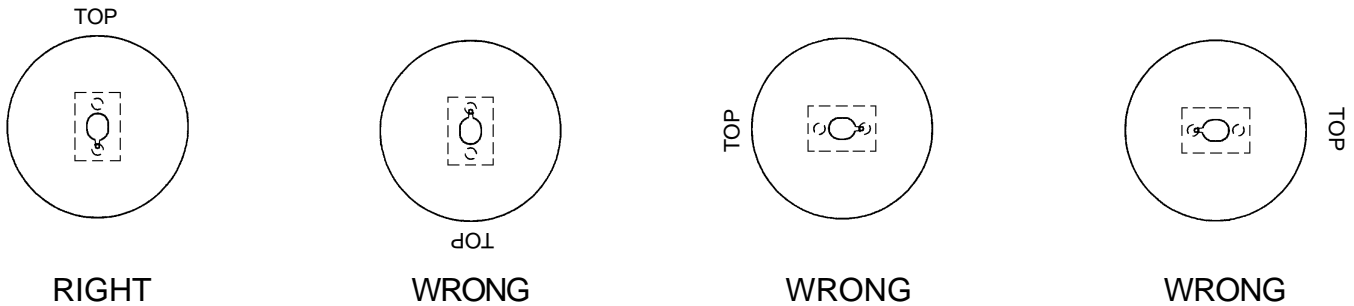

Note: The word "TOP" stamped on the back of the reflector refers to the reference position of the arc tube. This is done so that the arc tube "pinch seal" is in the down position or no more than horizontal when the bulb is tilted 90 degrees from this reference position. This keeps the pinch seal below the hot arc, and the seal temperature within specs. From this reference point, the bulb can be tilted up 90 degrees, or down 90 degrees.



NORTH STAR LIGHTING INC.

2150 PARKES DRIVE ♦ P.O. BOX 6038 ♦ BROADVIEW, ILLINOIS ♦ 60155-6038 ♦ 708-681-4330 ♦ FAX 708-681-4006

Web Site: www.nslights.com

THORN

PHOTOMETRICS

CANDELA TRACES

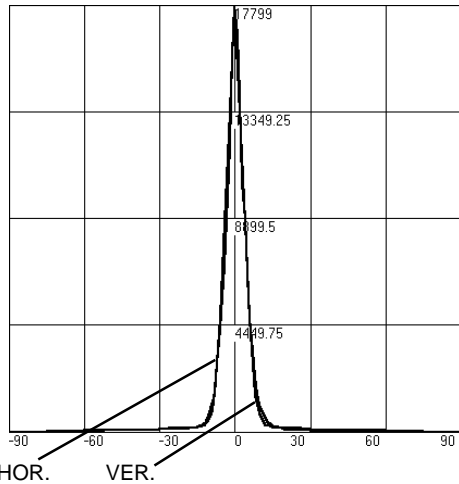

FIXTURE: CSI -1000C
LAMP: 1000 Watt Clear Metal Halide

| | |
|-----------------------|----------|
| IES TYPE | 1H x 1V |
| MAX CANDELA | 17799 |
| HOR FIELD ANGLE (10%) | 15.7 deg |
| VER FIELD ANGLE (10%) | 16.7 deg |
| FIELD LUMENS | 384 |
| FIELD EFFICIENCY | 38.4% |
| TOTAL LUMENS | 654 |
| TOTAL EFFICIENCY | 65.4% |

CANDELA & LUMEN VALUES ARE BASED ON 1,000 LAMP LUMENS. FOR OTHER LAMP LUMEN RATINGS, MULTIPLY CANDELA AND LUMEN VALUES BY THE NUMBER: LUMENS DIVIDED BY 1,000.

PER 1,000 LAMP LUMENS

ISOCANDELA CURVE / LUMEN DISTRIBUTION

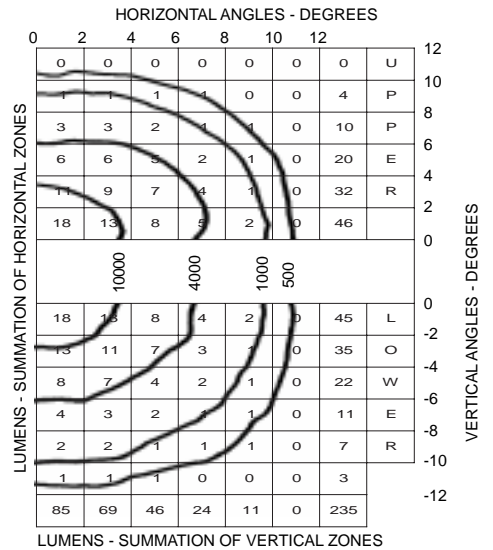

CANDELA TRACES

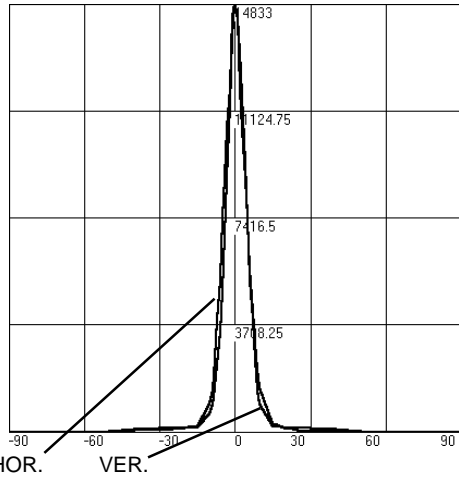

FIXTURE: CSI -1000S
LAMP: 1000 Watt Clear Metal Halide

| | |
|-----------------------|----------|
| IES TYPE | 1H x 2V |
| MAX CANDELA | 14833 |
| HOR FIELD ANGLE (10%) | 17.9 deg |
| VER FIELD ANGLE (10%) | 18.3 deg |
| FIELD LUMENS | 436 |
| FIELD EFFICIENCY | 43.6% |
| TOTAL LUMENS | 588 |
| TOTAL EFFICIENCY | 58.8% |

CANDELA & LUMEN VALUES ARE BASED ON 1,000 LAMP LUMENS. FOR OTHER LAMP LUMEN RATINGS, MULTIPLY CANDELA AND LUMEN VALUES BY THE NUMBER: LUMENS DIVIDED BY 1,000.

PER 1,000 LAMP LUMENS

ISOCANDELA CURVE / LUMEN DISTRIBUTION

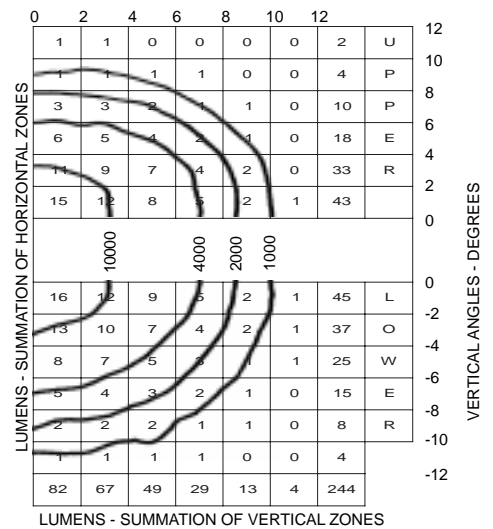

CANDELA TRACES

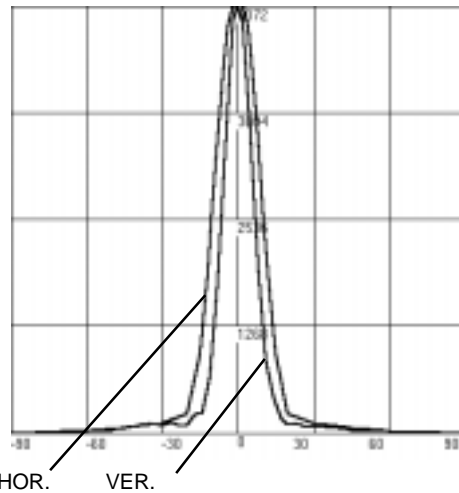

FIXTURE: CSI -1000P
LAMP: 1000 Watt Clear Metal Halide

| | |
|-----------------------|----------|
| IES TYPE | 3H x 2V |
| MAX CANDELA | 5072 |
| HOR FIELD ANGLE (10%) | 36.1 deg |
| VER FIELD ANGLE (10%) | 25.7 deg |
| FIELD LUMENS | 242 |
| FIELD EFFICIENCY | 24.2% |
| TOTAL LUMENS | 638 |
| TOTAL EFFICIENCY | 63.8% |

CANDELA & LUMEN VALUES ARE BASED ON 1,000 LAMP LUMENS. FOR OTHER LAMP LUMEN RATINGS, MULTIPLY CANDELA AND LUMEN VALUES BY THE NUMBER: LUMENS DIVIDED BY 1,000.

PER 1,000 LAMP LUMENS

ISOCANDELA CURVE / LUMEN DISTRIBUTION

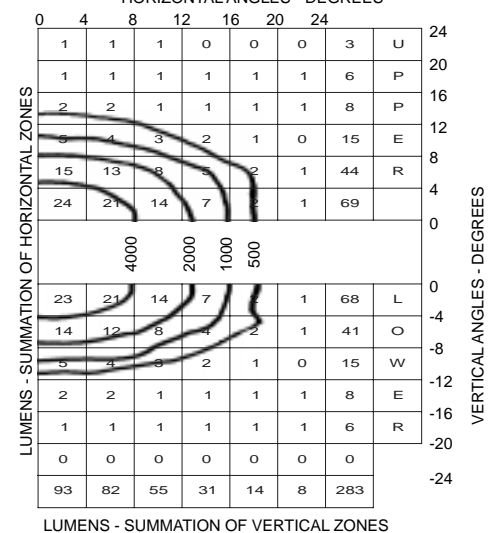

NORTH STAR LIGHTING INC.

2150 PARKES DRIVE ♦ P.O. BOX 6038 ♦ BROADVIEW, ILLINOIS ♦ 60155-6038 ♦ 708-681-4330 ♦ FAX 708-681-4006

Web Site: www.nslights.com

THORN

PHOTOMETRICS

CANDELA TRACES

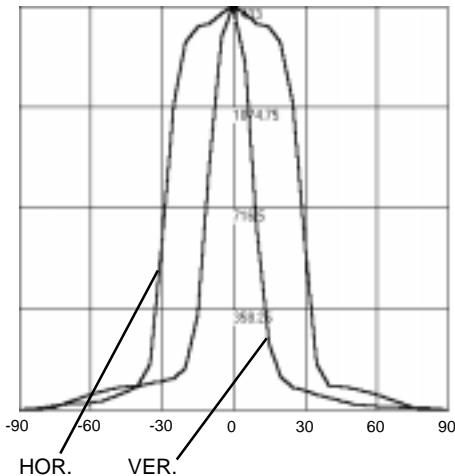

FIXTURE: CSI -1000W
LAMP: 1000 Watt Clear Metal Halide

| | |
|-----------------------|----------|
| IES TYPE | 5H x 3V |
| MAX CANDELA | 1433 |
| HOR FIELD ANGLE (10%) | 72.8 deg |
| VER FIELD ANGLE (10%) | 39.9 deg |
| FIELD LUMENS | 344 |
| FIELD EFFICIENCY | 34.4% |
| TOTAL LUMENS | 626 |
| TOTAL EFFICIENCY | 62.6% |

CANDELA & LUMEN VALUES ARE BASED ON 1,000 LAMP LUMENS. FOR OTHER LAMP LUMEN RATINGS, MULTIPLY CANDELA AND LUMEN VALUES BY THE NUMBER: LUMENS DIVIDED BY 1,000.

PER 1,000 LAMP LUMENS

ISOCANDELA CURVE / LUMEN DISTRIBUTION

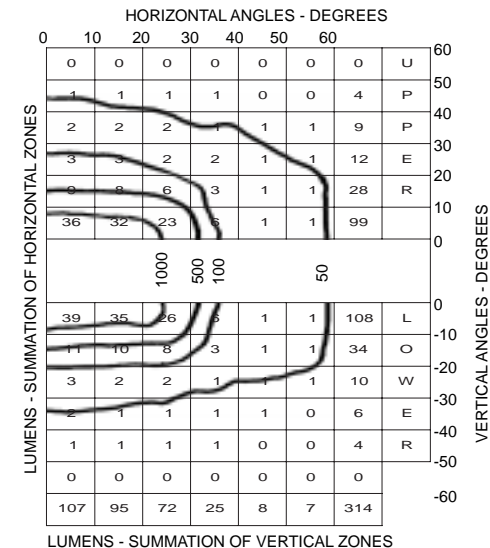

CANDELA TRACES

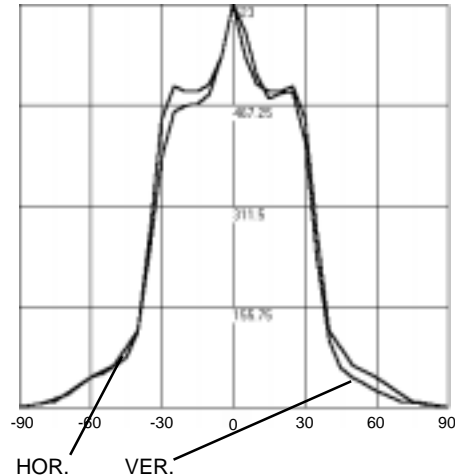

FIXTURE: CSI -1000E
LAMP: 1000 Watt Clear Metal Halide

| | |
|-----------------------|-----------|
| IES TYPE | 6H x 5V |
| MAX CANDELA | 623 |
| HOR FIELD ANGLE (10%) | 102.8 deg |
| VER FIELD ANGLE (10%) | 95.7 deg |
| FIELD LUMENS | 390 |
| FIELD EFFICIENCY | 39.0% |
| TOTAL LUMENS | 608 |
| TOTAL EFFICIENCY | 60.8% |

CANDELA & LUMEN VALUES ARE BASED ON 1,000 LAMP LUMENS. FOR OTHER LAMP LUMEN RATINGS, MULTIPLY CANDELA AND LUMEN VALUES BY THE NUMBER: LUMENS DIVIDED BY 1,000.

PER 1,000 LAMP LUMENS

ISOCANDELA CURVE / LUMEN DISTRIBUTION

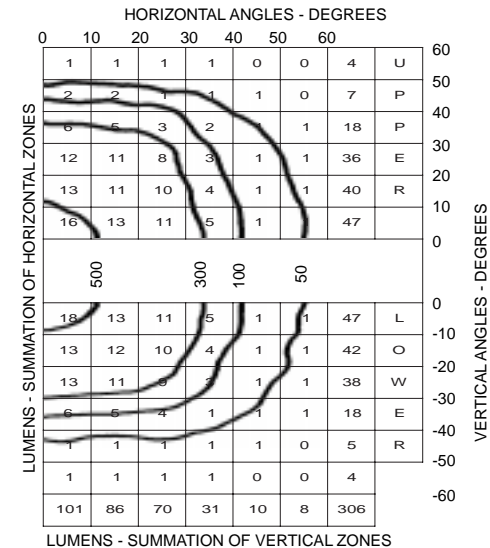

FOR ADDITIONAL INFORMATION CONSULT FACTORY



2150 PARKES DRIVE ♦ P.O. BOX 6038 ♦ BROADVIEW, ILLINOIS ♦ 60155-6038 ♦ 708-681-4330 ♦ FAX 708-681-4006

Web Site: www.nslights.com

THORN